

Termination Load Technology Manual

1. **Model:** BC-TE5000-01

2. **Product Name:** RF Termination Load

3. **Description:**

Frequency	DC~1GHz
Connector	N-K
VSWR	≤ 1.4
Average Power	5000W
Peak Power	100KW (5 μ s pulse width with 5% duty cycle)
Cooling Method	oil-cooled+ forced draft
Impedance	50 Ω
Temperature Range	-40° C ~ +45° C
Dimensions	905×340×930mm
Weight	110Kg

4. **Picture:**

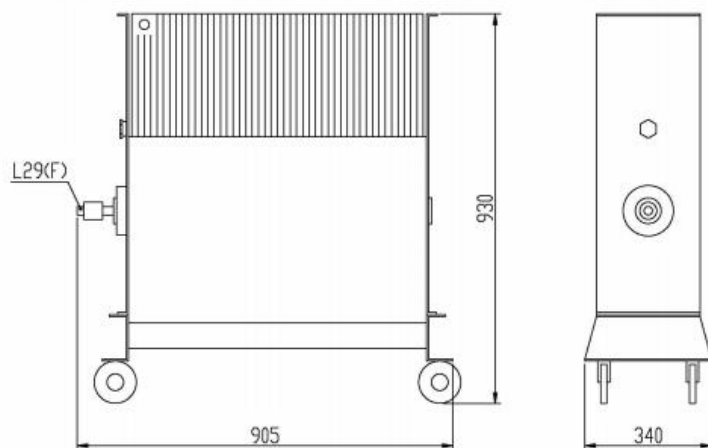

Tolerance: $\pm 2\%$